

重庆公路养护工程(集团)有限公司

G42奉万段安全韧性提升工程
拌合厂彩钢棚

施工设计图纸

二零二六年一月

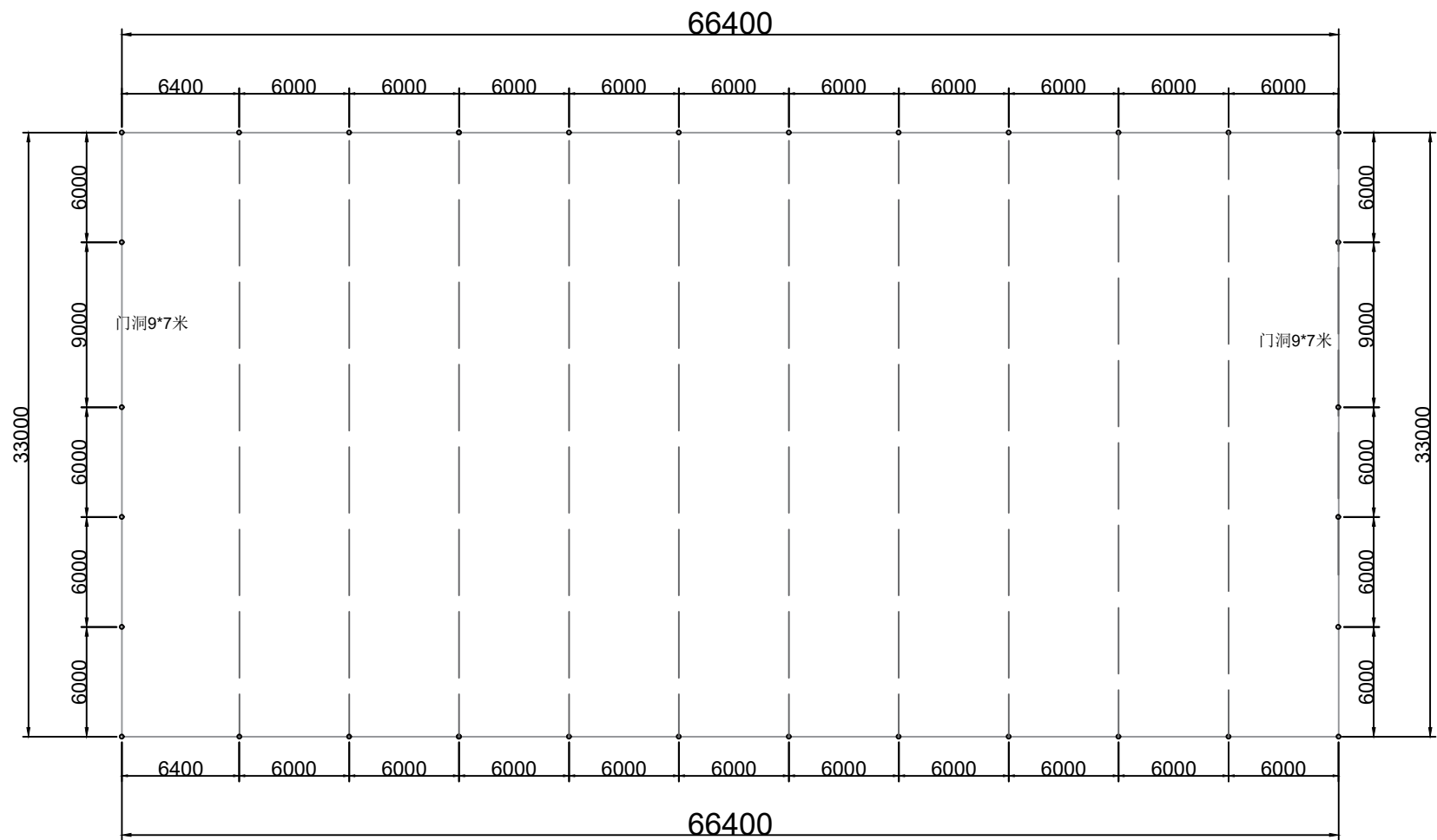

平面布置图

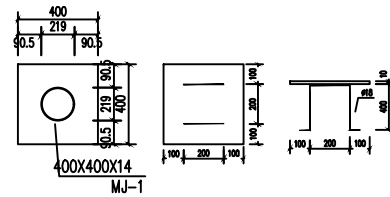
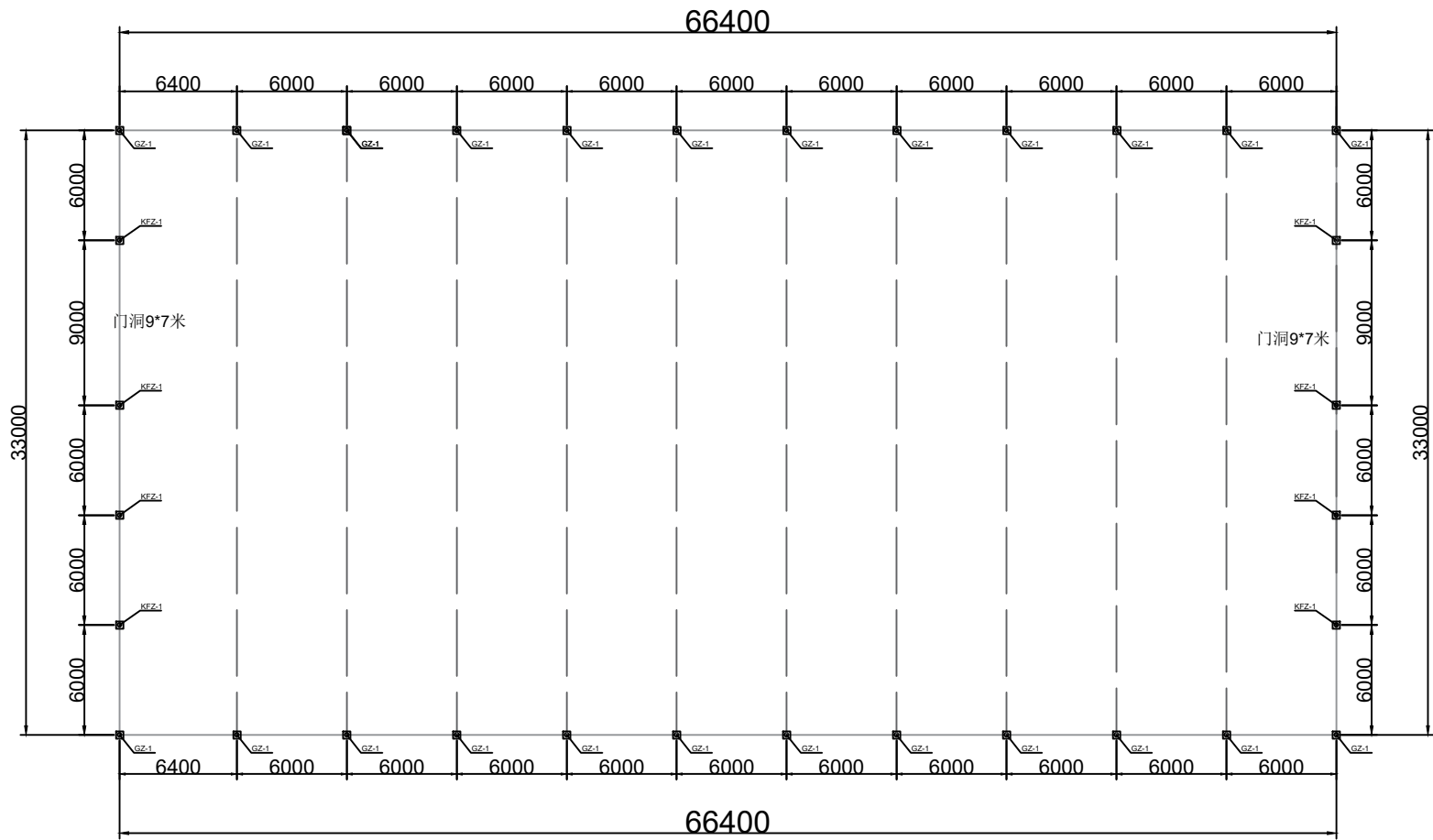

预埋件

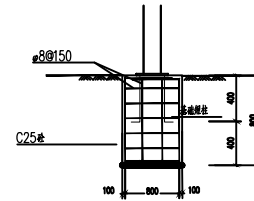

A-A



基础短柱配筋

钢柱预埋布置图

名称	规格	材质	备注
GZ-1	Φ219*3.0钢管	Q235B	主梁预埋
KFZ-1	Φ140*3.0钢管	Q235B	主梁预埋

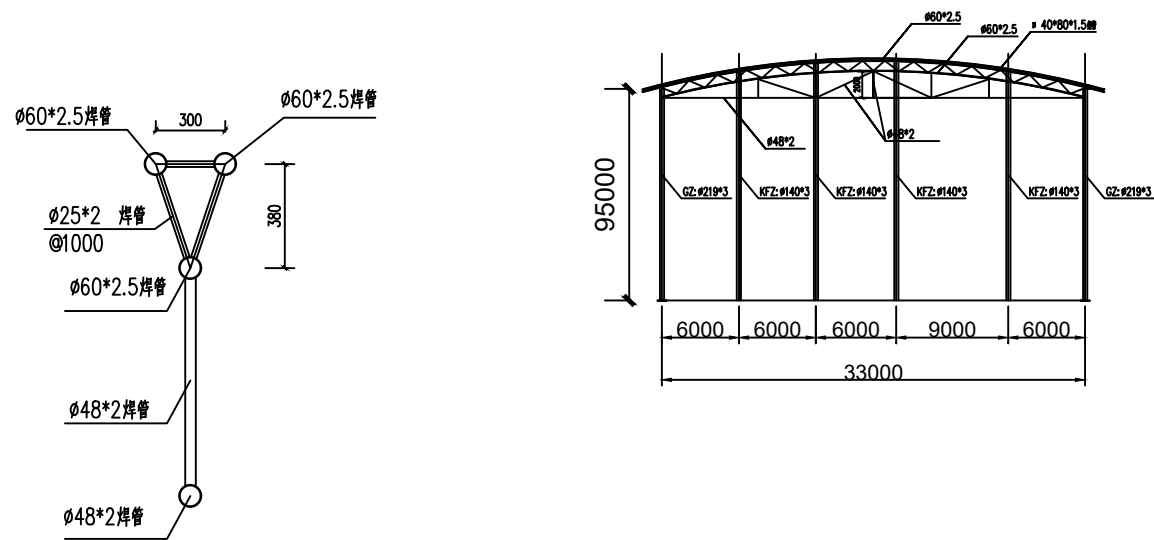

1-1 结构图

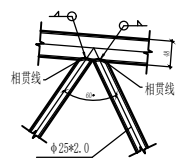

GWJ节点1

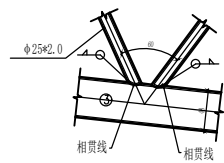

GWJ节点2

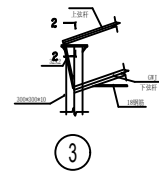

结构图

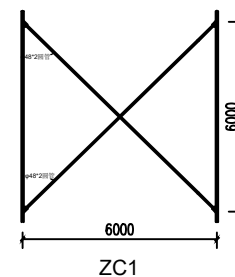
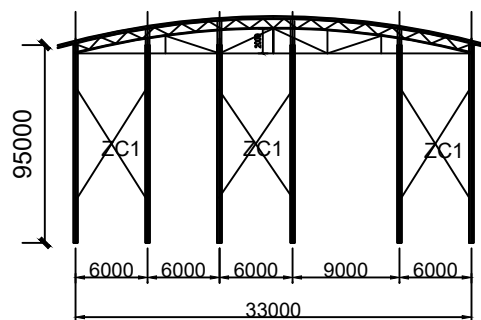
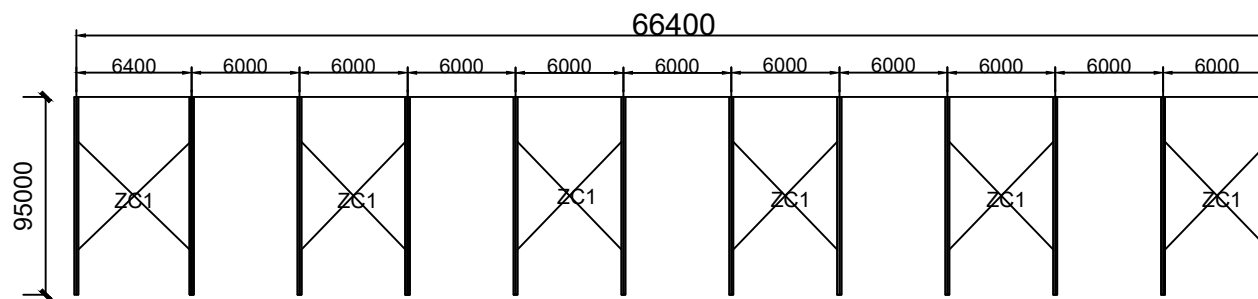

柱间支撑布置图

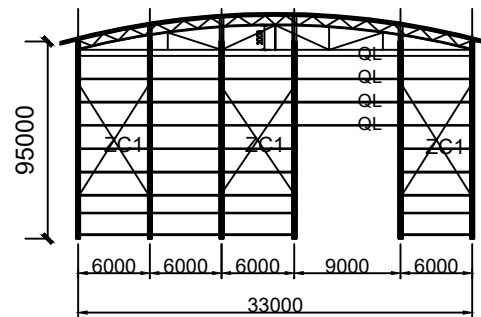
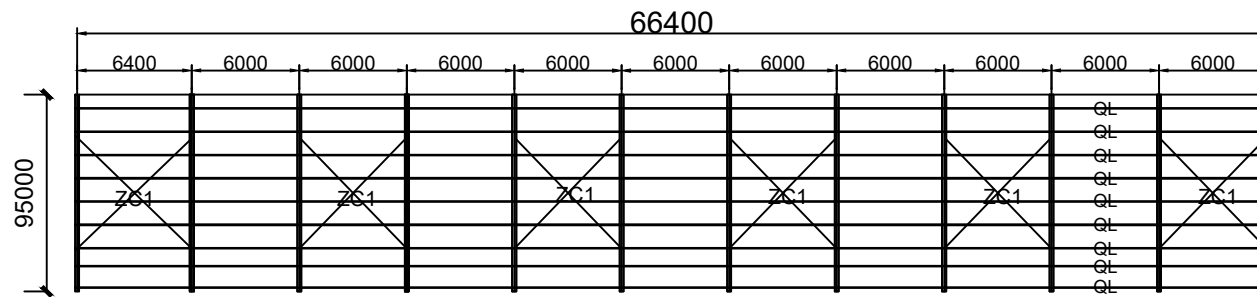

墙面檩条布置图

说明：图中QL(檩条)采用口80X40X1.5热镀锌矩管

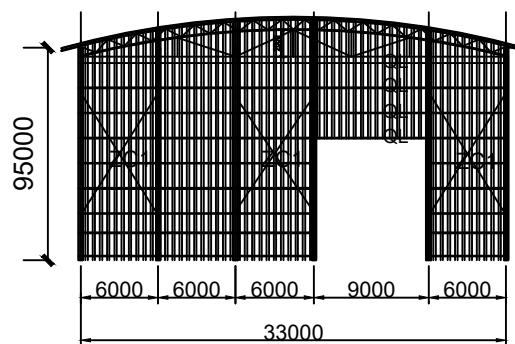
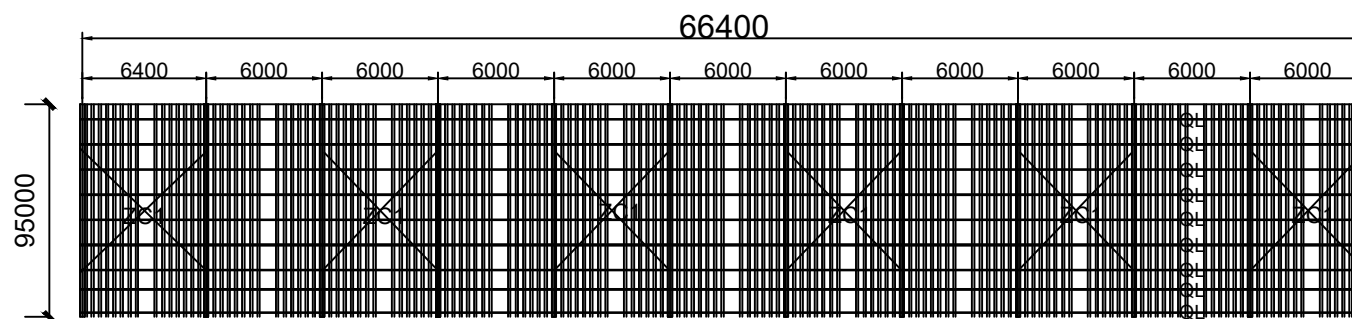

墙面瓦布置图

说明：图中墙面瓦为900型0.326MM蓝色彩钢瓦

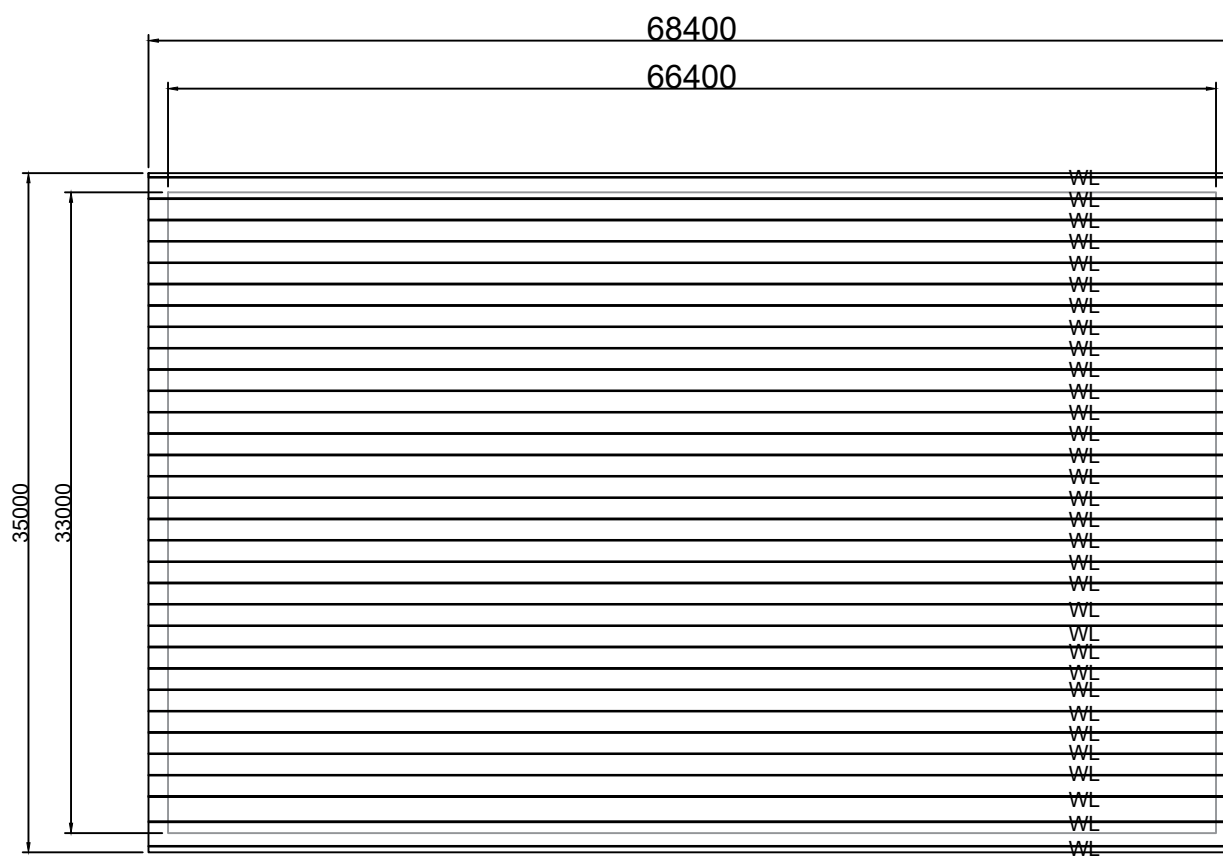

屋面檩条布置图

说明: 图中WL(檩条)采用口80X40X1.5热镀锌矩管

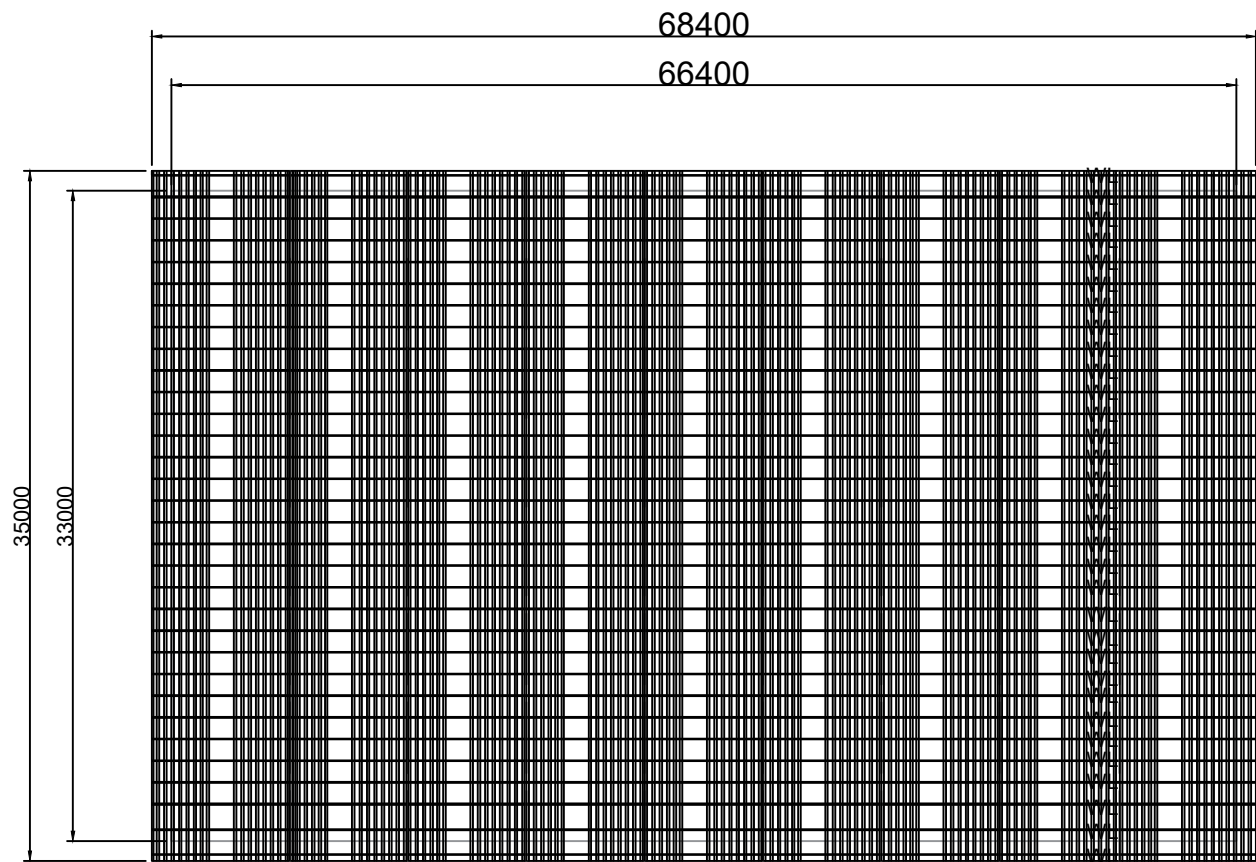

屋面瓦布置图

说明：图中屋面瓦为840型0.376MM蓝色彩钢瓦